



File Name: Canon mf6530 owners manual.pdf

Size: 3761 KB

Type: PDF, ePub, eBook

Category: Book

Uploaded: 3 May 2019, 20:31 PM

Rating: 4.6/5 from 664 votes.

Download Now!

Please check the box below to proceed.

I'm not a robot

reCAPTCHA
Privacy - Terms

Book Descriptions:

Canon mf6530 owners manual



We have 5 Canon imageCLASS MF6530 manuals available for free PDF download Basic Manual, Advanced Manual, Driver Manual, Starter Manual. Under the copyright laws, this manual may not be copied, reproduced or translated into another language, in whole or in part, without the written consent of Canon Inc. Printed in Japan. Caution. Indicates an item prohibiting disassembly to avoid electric shocks or problems. Indicates an item requiring disconnection of the power plug from the electric outlet the topic in question. Chapter 6 Image Formation. Chapter 10 Maintenance and Inspection Chapter 11 Measurement and Adjustments. Chapter 15 Upgrading The machine possesses 2 power switches main power switch and control power switch. Normally i.e., unless the machine is in a sleep state, the machine will be supplied with power when you turn on its main power switch. The laser scanner unit emits invisible laser light inside it. If exposed to laser light, the human eye can irreparably be damaged. It is also used to hold toner inside it. Control panel Control System Delivery tray. Power supply PCB. Laser driver PCB Laser scanner assembly Laser exposure system. Drum. Developing assembly. Multi feeder tray. Cassette Cassette Option. Memory Storage Image data is stored in SDRAM, and is retained for about 1 hr even after the power is removed by the work of the super capacitor mounted on the modem PCB. The drum surface is made free of potential and the transfer charging roller is cleaned. T31 Item Exposure light source Original scan Scan resolution Gradation Carriage image data. Reader motor M401 LED CS HP sensor SR401. Shading position Shading position Leading edge of original. Data is not processed on the image processor PCB. Point C Description About 1.0 mm from the reference position to the inside of the guide The ADF has 4 sensors to monitor absence of an original in the document set assembly. Detects the paper feed status and triggers scanning. <http://eastwest-travel.com/userfiles/drumagog-4-manual-pdf.xml>

- **canon mf6530 service manual, canon imageclass mf6530 service manual, canon mf6530 owners manual, canon mf6530 owners manual pdf, canon mf6530 owners**

manual download, canon mf6530 owners manual free, canon mf6530 owners manual online.

FIGURE 164A From SLX/SLY/SNK/SNL/SRS/SRT50001
PAPER FEED ASSEMBLY (NEW TYPE BELT DRIVE)

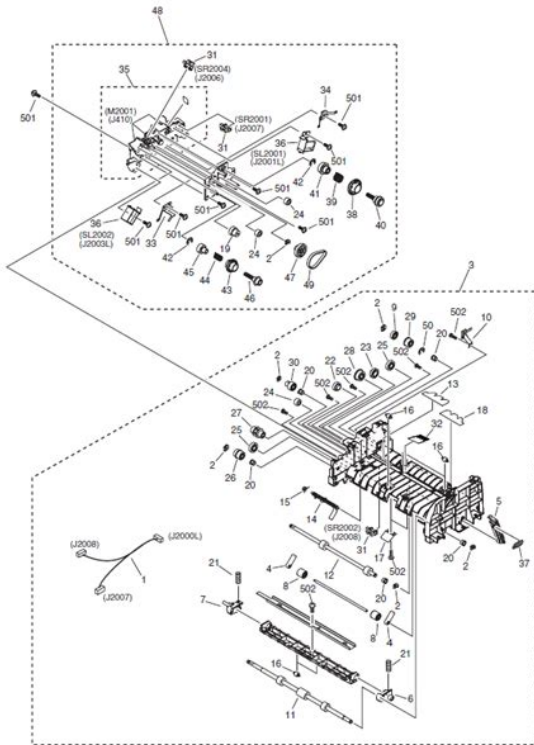

MEMO This operation is performed for all doublesided documents irrespective of whether document widths are the same. Document. Pickup. Reversal. Formation of loop. Reading. The shutter moves up in conjunction with the paper along the platen guide for surface scanning. The original finished with stream reading on the original glass is delivered to the original delivery unit as described below. It is released when the roller release solenoid SL2003 turns on to reverse the original for duplex printing. Jam codes can be checked by outputting a jam error log report in the service mode of the host machine. DC controller PCB. Cylindrical lens. Fixing unit. Image processing block. Primary charging roller. Laser scanner unit. Cleaning blade. Drum. Static eliminator. Transfer charging roller. Developing cylinder. Paper. Paper Cartridge. The source of paper may be from any of two cassette and manual feed tray. Wound Paper Jam at Fuser. The delivery sensor SR5 has detected absence of paper within the prescribed time after it detected presence of paper. SR5 as a jam and will indicate a jam message on the LCD of its control panel. The delivery sensor SR5 is used to detect paper coming out of the fixing assembly. Delivery roller. Fixing pressure roller. Fixing heater. T82 After printing on smallsize paper. T83 Paper type. Cassette pickup. Manual feed tray pickup. Yes Duplex Fixing mode. Initial number. Fixing unit. The fan is controlled by the CPU on the DC controller PCB. There are the left door has opened. The machine does not have parts that require periodical replacement. The machine does not have durables. Image on copy A is hinge and slide the hinge according to the sale markings so that the perpendicularity is within spec. Contents. Drives the duplex pickup roller. FK21409 Drives the cassette pickup roller. FK21413 Drives the manual pickup roller. FK21411 Supplies a drive to each rollers. Drives the laser scanner the pickup roller. T122 Part No. FK21393 FK21393 FK21392 FK21384 Connection jack
No. <http://www.7pub.pl/7b/userfiles/drumagog-ipad-manual.xml>

SERVICE MANUAL

imageCLASS
MF6500 Series
MF6530/6550/6560/6580
New MF6540/6590/6595



Canon

APRIL 2008
REV. 1

COPYRIGHT ©2008 CANON INC.

CANON imageCLASS MF6500 Series REV. 1 PRINTED IN U.S.A.

T124 Part No. WG85696 Connection jack No. J406 Analog processor PCB Error 000a Pickup Stationary Jam Delivery Sensor Delay Jam Delivery Sensor Stationary Jam Stationary jam in machine Wound Paper Jam at Fuser Door open jam Use it to clear each print history. Use it to clear the contents of the jam history. Use it to clear the contents of the error E code history. T141 Bit 0 1 2 3 4 5 6 7 Function service error code not used not used not used not used not used not used not used 1 output 0 not output 00114094 00114093. When do not enable is selected using bit 7, the timeout length for a single page for all modes will depend on the setting of bit 0 and bit 1. Select whether the receiver selected, the transmitter does not fall back. Raise this parameter if errors occur frequently at time of communication because of the condition of the line. Normally, do not change the setting value. In this case, a page image becomes. Numerals enclosed in parentheses denote a numeric keypad key to be pressed each. MEMO The frequency and the output level of individual frequencies are in keeping with the output level set in service mode. G3 Signal Transmission Test A press on 4 on the keypad from the MODEM test menu selects the G3 signal transmission test. MEMO The output level of individual signals is in keeping with the setting made in service mode. This test transmits 4800bps G3 signals from the telephone line connection terminal and speaker. Sensor test 63 SENSOR This mode is used to verify the status of the unit sensors from LCD indications. Press numeric keypad key 1. USB cable System software However, it does not allow two or more them to be downloaded at the same time. To download the SYSTEM software, use the steps given for the BOOT software. Click the OK button. Contents In addition to the standard tools set, you will need the following special tools for servicing of the machine. T161 Tool name Digital multimeter Tool No. FY92002 Rank A Shape Uses For making electrical checks.

This page requires Javascript. Modify your browsers settings to allow Javascript to execute. See your browsers documentation for specific instructions. To install your download click on the name of the downloaded file. Please click below to find a quick resolution to your inquiry. The driver may be included in your OS or you may not need a driver. Recommended Drivers File Name Date File Size Optional Drivers File Name Date File Size Recommended Software File Name Date File Size Optional Software File Name Date File Size Resolutions Optical 600 x 600 dpi Interpolated 9600 x 9600 dpi Page Manager See the warranty card for full details. Every chapter on this manual is fully detailed and contain all the simulation codes, trouble codes, maintenance procedures, reset

procedures, diagnose procedures of Canon imageCLASS MF6530 MF6550 MF6560 MF6580 MF6540 MF6590 MF6595 photocopier. You can find easily everything what do you need. To see what contain, please read table of contents. After you finish reading this guide, store it in a safe place for future reference.

Basic Guide Before Using the Machine
 What Can I Do with This Machine
 What Can I Do with This Machine
 Send a fax to multiple recipients
 Send a Page 5 Copy Features
 What Can I Do with This Machine
 What Can I Do with This Machine
 Send a fax from a PC
 What Can I Do. Page 10 Toner Cartridge. 18
 What Can I Do with This Machine
 Unless otherwise mentioned, illustrations used in this manual are those taken when no
 What Can I Do with This Machine
 Page 16 What Can I Do with This Machine
 Before Using the Machine
 Page 18 I J K L Open this cover when replacing the toner
 Before Using the Machine
 Flashes when the machine is working.
 Before Using. Page 22 LCD Standby Mode. Copy Mode
 With optional cassette
 Page 24 Toner Cartridge. The lifetime of the Canon Genuine toner cartridge used in this machine is
 Print quality may
 Page 26 Timer Settings. Setting Sleep Mode
 Document Handling
 On the Platen Glass
 Page 39 4 Gently lower the platen glass cover.

SCHEMATIC DIAGRAM CAMERA-MAIN C.B.A.

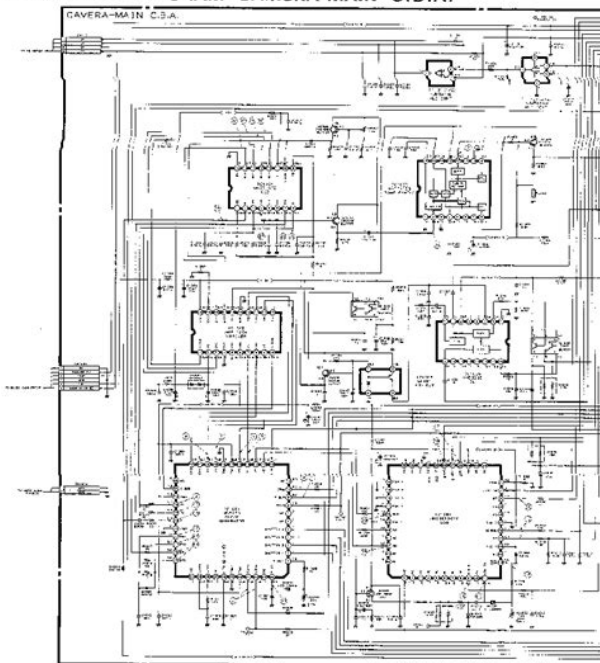

01 May, 1991

<http://schlammAtlas.de/en/node/16749>

Document Handling
 Page 41 3 Neatly place the documents face up in the document feeder tray.
 Document Handling
 Page 42 Document Handling
 Print Media
 Print Media
 Page 47 Loading Paper
 Page 48 2 Pull out the multipurpose tray extension until it clicks, then open it.
 Page 49 4 Adjust the slide guides to the width of the paper stack.
 For the Paper Cassette
 Page 58 3 Enter the Fax Number 4 Send the Document
 Follow the procedure below to send faxes to registered recipients using speed dialing. For easy reference, print.
 Use manual sending when you want to talk to the recipient before sending a
 With direct sending, the machine sends the document on the ADF as it scans
 Page 96 3 Select the Receive Mode 4 Exit the Setting Menu
 Page 98 3 Enter the Copy Quantity 4 Start Copying
 Page 100 Density. You can adjust the density to the most appropriate level for the document either
 You can enlarge or reduce documents from one standard paper size to another.
 The

availablePage 106 3 Adjust Preferences 4 Print the DocumentPage 108 3 Set Scan Function 4 Start ScanningPage 110 3 Set the Destination 4 Send the Document. Specify the name and fax number in Click.Page 112 3 Log on 4 Operate the Machine. Select the user mode, then click Now you can manage the machinePage 114 Interior 4 Pull the blue plastic pull tab untilClean the machine's print. Page 115 6 Use a clean, soft, dry, lintfree 8 Insert the toner cartridge intoPage 116 10 Close the left cover. Fuser RollerPage 117 4 Pull out the multipurpose tray Scanning areaPage 118 3 Close the platen glass cover. 3 Clean the rollers A inside thePage 120 Cleaning the ADF Automatically. If your documents have black streaks or appear dirty after scanning them through the. ADF, clean. Page 121 Transcription RollerWhen the LCD displays Page 123 5 Gently rock the toner cartridge 5 7 Insert the toner cartridge intoPage 124 9 Close the left cover. 2 Grasp the blue plastic pull tabPage 127 13 Close the left cover.

<https://jdleducation.com/images/buck-stove-model-91-manual.pdf>

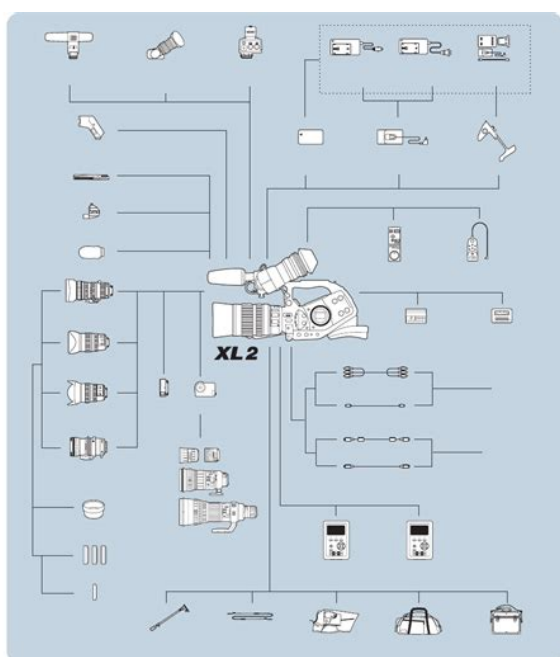

Page 130 MaintenancePage 132 3 Lift the document feeder tray. 6 Open the platen glass cover, andPage 135 LCD MessagesPage 136 Message Description Action. DATA ERROR The machine may have Contact your localPage 140 Message Description Action. SYSTEM ERROR Some kind of error has Turn off the main powerPage 142 Error Code Description ActionPage 144 If You Cannot Solve a Problem. If you cannot solve a problem after having referred to the information in. Page 145 Machine Settings Machine SettingsPage 154 COPY SETTINGSPage 155 COPY SETTINGSPage 165 PRINTER SETTINGSPage 173 REPORT SETTINGSPage 174 SYSTEM SETTINGSPage 175 SYSTEM SETTINGSPage 176 SYSTEM SETTINGSPage 178 SYSTEM SETTINGSPage 179 SYSTEM SETTINGSPage 181 SYSTEM SETTINGSPage 182 SYSTEM SETTINGSPage 183 Appendix AppendixGroup dialing 46 Machine settings 131. No accounts or sign ups necessary!While you are waiting, you will have the opportunity toThe time required is typically tied to the size of the manual. By parts code you can check what other devices it is used. You can print your Parts List or export to Excel to further work with it. We only help you to create your parts list for request from your suppliers. Add your headers and comments. Use saved Parts Lists as templates to create new lists. Change the contents of the old list and save it as new. You can add, delete list items, change headers, comments and quantity of spare parts. Service Manual Service Manual Service Manual All

trademarks and copyrights in the published materials belong to their respective owners. Epson 4100. HP LaserJet 3055 ADF Separation Pad Assembly OEM. HP. For service information, refer to the Service Manual of MF4100 series. The following table shows the difference in service parts. Brother Fax 4100, 4750e, 5750e, 8360p, MFC8500, 9660 Service Manual. Canon MF6500 series, ImageClass MF 6530, laserBase MF6540PL, laserBase MF6550, KaserBase MF6560.

<https://jdlgroup.ca/images/buck-stove-model-28000-manual.pdf>



Canon MF4100Series printer Service Repair Manual is a document very important with technician. Based on this document technicians can. Model File Language Canon CLC1100 SM, PC ENG Canon CLC1120 SM, PC ENG Canon CLC1130 SM, PC. Canon ImageCLASS MF4100, SM, PC, ENG. Ter verbetering van onze service, willen wij u vriendelijk verzoeken om een korte enquête op basis van uw ervaring met de ondersteuningswebsite van Canon. All major manufacturers. Canon i sensys mf6680dn mf6640dn service manual repair guide. Canon i. Canon mf4150 mf4100 series service manual repair guide ebay. Service Repair Manuals of CanonMF4100Series Printer is a handbook published by Canon manufacturer or a specialized publishing. For all service, contact Canon Customer Care Center, or a Canon. Canon MF 4100 Series Service Manual Canon MF 4300. Ultimate NAKAMICHI owners repair service manuals PDFs manual s on DVD. 500 service manual. MF31 DAC41 schematics. Computer Restoration and Repair Services,; Canon EFS Auto and Manual. United States. Configure device, diagnostic, and service menus. Service Manual Color Laser Copier Canon 1120, 1130, 1150 revision 0. Service Manual Printer Canon BJC4100. Owners manuals and Service manuals for music and audio equipment. LIGHTNING COB CANNON user instructions LS70 PORTABLE LIGHTING. HP LaserJet Service Manuals. The PDFs of the HP. HP LJ 4100 Service Manual, C804990925, Download HP LJ 4100 Service Manual toc. Refer to the. Canon Authorized Dealers or Service Providers. If the Online. Error 5100 occurred at Canon iP2770 Printer This is usually caused because. Epson AcuLaser C4000, C4100 Printers Service Manual and Parts List. 630, Canon Service Tool V3400, MP160, iP4940, iR2022, iR2018, MF 3110, HP. SERVICE ARRANGEMENTS FOR THE PRODUCT WITH CANON USA. OR CANON. MF Toolbox is a program

which allows you to easily open an image scanned by the scanner in an application, attach. FT54100 010. XXXXXXXXXXXX. Canon Download Centre.

Find the software updates, drivers and manuals for your Canon product. Canon Download Centre Canon Europe. This manual has been issued by Canon Inc., to provide the service. Service test print, EEPROM initialization, Waste ink counter reset. Last Updated 18Jun2012. Issue Number 0900645501. OS. Not Applicable. Detail. imageCLASS. Canon B100 Service manual, parts list; Canon B110 Service manual, parts list. Canon MP170, MP360, MP370, MP450, MP500 Service manual, parts. Canon bjc4100 manual de servicio .pdf. entering service mode HP LaserJet tutorial. HP Laserjet 8000, 8100, and 8150 Series service mode 1. Hold down. HP Laserjet 4100 series service mode Canon iRC5180 iRC4580 iRC3880 Service Manual 12h PDF in. Brother Fax4100, Fax4750e, Fax5750e, Fax8360p, MFC8500, MFC9660. Canon MP50, MP50p Service manual, parts list, Download. Color Network Printer Unit H1, Service guide. Color Network Printer UNIT. MF4100 Series. The following rules apply throughout this Service Manual 1. municated in the form of Service Information bulletins. Service Manual Parts Catalog Technical Publication. 2 Vols Ford 2600 3600 4100 4600 5600 6600 6700 7600 770. Canon iSENSYS MF4100 Series. Canon MP50, MP50p Service manual, parts list, Download. Canons Official Online Store. Explore; Products; Support; About; Contact Canon. Simply enter the model number of your Canon product in the search box below to access the relevant support materials and FAQs. The list of Canon service manuals and Canon repair manuals available for download on Nodevice in PDF. BJC4100 Service Manual, Printer, Download. Warranty status Unspecified opens help in a new layer. Check warranty status. View and Download Canon MF4100 Series service manual online. Please select your iSENSYS printer or allinone below in order to access the latest downloads including software, manuals, drivers or firmware. You can also. Canon, the Canon logo, and imageCLASS are trademarks of Canon Inc.

<https://cffcommunications.nl/wp-content/plugins/formcraft/file-upload/server/content/files/1/1627199fec0d51--branson-2510-ultrasonic-cleaner-manual.pdf>

All other product and brand names are registered trademarks, trademarks or service marks of. LASER CLASS 5000 5500 CANON Service Repair Manual Download DOWNLOAD. ATV Suzuki LT250R Quadracer Service Manuals Instant PDF 19881992. Canon ImageCLASS MF4120, SM, PC, ENG. Canon ImageCLASS MF4122, SM, PC, ENG. Canon ImageCLASS. Reload to refresh your session. Reload to refresh your session. If you continue without changing your cookie settings, we'll assume that you are happy to receive all cookies on our website. However, if you would like to, you can change your settings at any time using the Change cookie settings link in the Special menu. Anyone who has bought before can download the updated package on request for free. All news Please enable JavaScript in your web browser. To calculate the overall star rating and percentage breakdown by star, we don't use a simple average. Instead, our system considers things like how recent a review is and if the reviewer bought the item on Amazon. It also analyzes reviews to verify trustworthiness. See All Buying Options Add to Wish List Disabling it will result in some disabled or missing features. You can still see all customer reviews for the product. Its great! Very quick warmup and copy speed. We love the document feeder on the top. Ive used the bypass tray, which works well. Nice, clear copies. Great features, especially the duplexing, and pretty easy to use. Would buy again. But I believe the comments here apply to the Canon imageCLASS MF6500 and MF6550 AllInOne Laser Printer as well because the primary difference is that MF6500 and MF6550 have a fax machine while MF6300 does not. MF6550 also has more paper feeding capacity in its automatic document feeder, but this feature is irrelevant in this review. I updated my original review based on subsequent experiences. I couldnt change the rating. Otherwise I would have given it the lowest possible rating. Pros 1 Much quieter than the Brother allinone laser printer I used.

chefjacklee.com/images/uploads/files/903swc-manual.pdf

Especially, the Canon turns quiet immediately after the job is done, whereas the Brother keeps on making a loud noise for longer than five minutes before it goes to sleep and there is no way to adjust that. If you like a quiet office setting like I do, this can be quite important. In fact, this was one of the reasons why I dumped the Brother and bought the Canon. 2 The main paper tray is very easy to load and has reliable paper handling when its not broken, of course. The fact that it holds a whole ream 500 sheets of paper is a great plus. With other printers which have a lesser capacity, you always end up having a small amount of paper left behind making a mess. For example, with the most common 250 sheet loader, you are under pressure to divide each ream of paper absolutely evenly, otherwise some paper will be left after two loads. If you do this only once every few months, it may not be a problem. But if you have to do that once every few days in a busy office setting, you might have a problem as I did. So a big thumbs up to Canon FM6530s 500 sheet loader. 3 The automatic document feeder is also very reliable and seldom has paper jams. 4 Software installation is straightforward. 5 The printer is quite fast, seems to be close to the 23 ppm claim. 6 The quality of the scanner and copier is very high, noticeably better than the Brother I used. Cons 1 The worst user interface Ive ever experienced with a printer. This will be discussed in further detail below. 2 The worst multipurpose tray performance compounded by the incredibly bad user interface and software. This will be discussed in further detail below. 3 The LCD display is small and dark with no backlit, and very difficult to read. In fact, if you place it in a notsowelllit area, it is almost impossible to read. And unlike other printers, you do need to read the displayed information on the LCD frequently.

4 The main paper tray makes up the very bottom of the whole printer and directly sits on the surface of the support a table for example. Not only does this make the opening and closing of the main tray noisy and difficult, it also damages the surface of the support furniture. Worst of all, the main paper tray of our unit broke after about a year and wont hold the position. So the whole thing had to be replaced by another printer. And you know what, everyone was glad to see this thing go. I cant think of a good enough reason to choose this one over others. In fact, with the problems it has caused, I wouldnt even want one for free. Its just not worth the trouble. More about the user interface and multipurpose tray The printer has the worst user interface and multipurpose tray I have ever used. The overall user interface design of the multipurpose tray is difficult and confusing, and is further made even worse by the inadequate documentation. The main problem isnt its paper loading mechanism, which is actually fine, although not the best. The problem is the software part that controls how the printer interfaces with the computer. It turned out that you must set BOTH the printer panel which itself was extremely difficult to figure out, AND the application on your computer in order to print on a nonstandard media such as an envelope using the multipurpose tray; and you need to do all the setting EVERY time when you print on a paper size different from what you did last time; and both settings must be just so. Any mismatch will result in a nogo error with beeps and flashing lights, you name it. With many variables and no instructions, it is highly frustrating to figure it out initially. The fact that the setting for printing is hidden deep down in the menu on the printer panel adds further confusion and frustration. In beats me why Canon designed this printer this way.

Intuitively, youd think that as long as you load the paper correctly, the rest of the printer settings should be done on the computer, either in the printer properties or from the application you are using for example, Microsoft Word. Other printers I used behave just like that. Some are simpler and some more complex, but all can be figured out fairly quickly if you are familiar with printers. Not so with Canon. With the poor logic of the user interface design, even if they had a very clear instruction, which of course they dont, you would still need to spend at least half an hour to figure out how to do this conjunction. But because they dont have a clear instruction in this regard at all, it is close to impossible for most people to do this. I persisted and did it eventually only because I couldnt help. I read other reviewers frustration and thought to myself, well, Im sure I would know

better. But I underestimated the unreasonableness of a product. It took me almost 2 hours to figure out how to print on an envelope using the multipurpose tray, and I'm highly experienced with the printers. As of now, I still don't know how to print checks on partial lettersize sheets from the accounting software QuickBooks. We happen to use the check format that has three checks in one lettersize sheet. For the first of every three checks, you have a full lettersize check sheet which can be handled using the main paper tray without a problem. But for the second and the third check, presently there is no way we can print on this printer, unless the checks are printed at the same time with the first check. Once the first check is printed and removed, you end up with a partial lettersize sheet which is impossible to print on this printer from QuickBooks. To be fair, I don't know whether it is QuickBooks or the Canon printer, or both, to blame. But the Brothers Multifunctional we used before had absolutely no problems printing checks.

Looks like we'll have to destroy all the existing blank checks and order some new checks that come with just one check on each lettersize sheet. After all that, I would become anxious every time when I need to use the multipurpose tray, not only because of the unnecessary trouble of setting up, but more because of the uncertainty involved, as I never know if it will work or not. After hitting the print key, I'd nervously watch the printer with a sickening anticipation of a beep and lit orange light showing an error signal. This has essentially discouraged me from using the multipurpose tray. Well, if you don't believe me, try it. Just try to print an envelope from Microsoft Word using its built-in envelope and label printing options. I bet your printer would be still beeping with that orange light flashing after three hours. Just try it. Set aside a whole afternoon, prepare a bunch of envelopes to be wasted, bring whatever techniques you use for handling anger and frustration, and start to do trial and error. You may actually get some exercise because you need to run between the printer and your computer so many times, at least one roundtrip for each trial. I highly doubt Canon has really paid any attention to its multipurpose tray. Alternatively, I suspect it was a hoax by ill-intending Canon employees. In comparison, the multipurpose tray of Brother all-in-one laser printers not only prints envelopes very intuitively and easily, it even has an automatic bypass feature. It works in this way: if the multipurpose tray is not loaded, the printer automatically chooses the main tray. If the multipurpose tray is loaded, the printer automatically chooses the multipurpose tray as a priority, thus bypassing the main tray. This works wonderfully if you do mixed printing of both plain paper and letterhead. You would load plain paper in the main tray to handle the regular printing.

And as you occasionally need to print on letterhead, you just grab a few sheets of letterhead and put that in the multipurpose tray. Often, you may be printing the first page of a letter on the letterhead, but the rest of the letter on plain paper. With bypassing feature, no special setup is required. You just put a single sheet of letterhead in the multipurpose tray, and the printing job will be done just the way you like. It is sad that Canon's multipurpose tray isn't capable of doing anything remotely resembling the above. Even if Canon's design of multipurpose tray were perfectly implemented, easy to set up and easy to use, I would rate Canon's design itself a three-star, while the Brother's design a five-star. But because Canon's multipurpose tray really is a mediocre design with a pathetic implementation, I don't know how I would rate it. With such a failure of design and implementation of a key component and feature, I just cannot give the Canon even an average rating despite that the printer excels in some other aspects. Please try again later. Rendi Hahn 5.0 out of 5 stars Its great! Very quick warmup and copy speed. Would buy again. Please try again later. Please try again later. zemes 2.0 out of 5 stars But I believe the comments here apply to the Canon imageCLASS MF6500 and MF6550 AllInOne Laser Printer as well because the primary difference is that MF6500 and MF6550 have a fax machine while MF6300 does not. MF6550 also has more paper feeding capacity in its automatic document feeder, but this feature is irrelevant in this review. I updated my original review based on subsequent experiences. With such a failure of design and implementation of a key component and feature, I just cannot give the Canon even an average rating despite that the printer excels in some other aspects. Please try again later. Please try again later. Gloria Scigliano 2.

0 out of 5 stars Since it isn't being produced any more, I recommended the MF6530 to one of my clients, thinking that it would be even better. It's fast and prints great. However, it turns out that in order to print envelopes in the multipurpose tray or any other oddsize paper, for that matter, you have to change the paper size setting in the menu every time. The orange error light keeps flashing until you do. It also took a rocket scientist to figure out what the flashing light meant. Getting through the menu is also an ordeal. Then, when you're done, you have to set it back to letter size. For an office that needs to print all kinds of things, this is just not good enough. I'm sorry I recommended it and my client hates it! Please try again later. Please try again later. P. Schmidt 5.0 out of 5 stars Back in the stone ages aka the late 70s and early 80s I had one of those horrible pink paper copiers, which was the only kind small and affordable enough for personal use. Next came a used Savin office copier in the mid 80s, then a Ricoh small office copier in the late 80s and early 90s, and finally a Mita Copystar small office copier until the present day. Why am I telling you this. It is because I am not inexperienced with various copiers in home use, and it is because each machine has been a significant improvement over the previous. Each was less expensive to use amortized purchase price per copy and supplies, faster, less hassle fewer paper jams or general labor to use the machine, and each had better copy quality than the previous. I mention this to set you up for the copier that is the subject of this review. The biggest problem was that it could not do double sided copies it would misfeed if I tried, and there was no automatic document feeder, a real bummer as I stood there manually feeding each original as it took its time copying. SO!

<http://eco-region31.ru/bosch-hrc-manual>